



# CATALOGUE



## Working alongside the smile professionals for over 50 years

Every day we work with passion and skill to make the best removable dentures available to orthodontists and dental technicians. The most important thing to us is the most natural in the world: our clients' smiles. We take care of your smile!



- 7 Acrylic teeth
- 13 Acrylic teeth - Subsidiary products
- 16 X-Ray diagnostic materials
- 18 Resins
  - 19 C&B resins
  - 20 Resins for trays and Alginate
  - 21 Hot cure resins for removable prostheses
  - 22 Self cure resins
- 23 Resins for 3D stamp
- 23 CAD/CAM materials
- 26 Plasters
- 28 Duplicating Materials
- 31 Investments and Plastiform
  - 31 Investments
  - 32 Plastiform
- 35 Polishing and finishing products
- 38 Waxes
- 43 Digital





## ACRYLIC TEETH

# Acrylic teeth

## ACRYSMART

MEDICAL  
DEVICE

Acry Smart is the innovative system of acrylic resin artificial teeth providing excellent prosthetic results while being more versatile, resistant and aesthetically natural than ever.

**Range of** 16 shades, 15 moulds of upper anteriors, 7 lower anteriors and 16 posteriors.



### Advantages:

#### Funcional:

Front teeth by Acry Smart provide full individualization of the functional dynamics maintaining superior aesthetics.

#### Easy:

AcrySmart facilitates mounting for both the tooth-to-tooth concept and tooth-to-2-teeth method.

#### Smart:

they have been produced with three different occlusal morphologies so that the dental technician can use a more or less youthful design and integrated with the surfaces of functional occlusion.



#### Durable:

with its special conguration of the furrows of development of the rear teeth, offers superior grinding efficiency. This is maintained over time, including in cases of worn cusp regions.

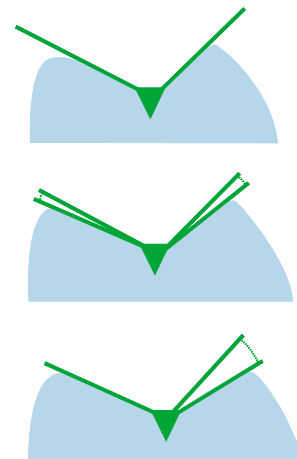

#### Versatile:

The special molecular structure of Acry Smart allows the dental technician to transform resin teeth used for mounting directly into di-silicate or into glass-ceramics.



Product	Code
Acry Smart 6 Upper	0120090
Acry Smart 6 Lower	0120091
Acry Smart 8 Upper	0120092
Acry Smart 8 Lower	0120093
Acry Smart Set 28 Teeth	0120094



# ACRY PLUS<sup>evo</sup>

MEDICAL  
DEVICE

Acrylic teeth realised to get the best results with:

- Complete prostheses
- Overdentures
- Toronto bridges
- All-on-four
- Bar prostheses

**Range of** 16 shades, 8 moulds of upper anteriors, 5 lower anteriors and 12 posteriors.

Acry Plus is compatible with the EVO2ST line, the 2-layer tooth with the same assortment of shapes.



## Advantages:

### Aesthetic

Texturing and characterisation give a natural finish to the teeth. Wide neck forms enable easier aesthetic adaptation of the prosthesis to the structure beneath.



### Function

Tooth to tooth occlusion reduces the contact points, reducing the trauma to the structures beneath the prosthesis.

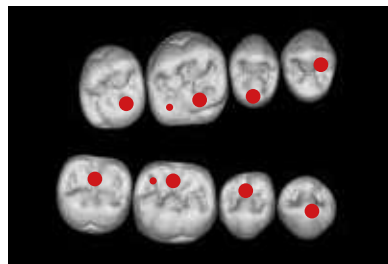

### Ease of use

The special form of the posterior neck zone simplifies and speeds up the mounting process, with no need to grind the heel of the tooth.



Product	Code
Acry Plus Evo 6 Upper	0120036
Acry Plus Evo 6 Lower	0120037
Acry Plus Evo 8 Upper	0120038
Acry Plus Evo 8 Lower	0120039
Acry Plus Evo Set 28 Teeth	0120042

# Evo 2ST

MEDICAL  
DEVICE

**EVO 2ST is a two layers tooth of high aestetel value ideal for dentures in implants.**

EVO 2ST is available in the same moulds of Acry Plus Evo facilitating the handwork between temporary and definitive denture.

**Range of** 16 shades, 8 moulds of upper anteriors, 5 lower anteriors and 12 posteriors

Product	Code
EVO 2ST 6 Upper	0120080
EVO 2ST 6 Lower	0120081
EVO 2ST 8 Upper	0120082
EVO 2ST 8 Lower	0120083
EVO 2ST Set 28 Teeth	0120084



# Acrylic teeth

## ACRY PLUS

MEDICAL  
DEVICE

**4 layers Acrylic teeth for removable denture.**

**ACRY PLUS: range of** 19 shades, 22 moulds of upper anteriors, 12 lower anteriors and 10 posteriors.

**ACRY PLUS V: range of** 16 shades, 28 moulds of upper anteriors, 12 lower anteriors and 10 posteriors.



### Advantages:

- High hardness
- Excellent resistance to abrasion
- Colour stability
- Good resistance to plaque adhesion
- Large assortment of moulds and shades



The range of incisors includes square, triangular and oval shapes.

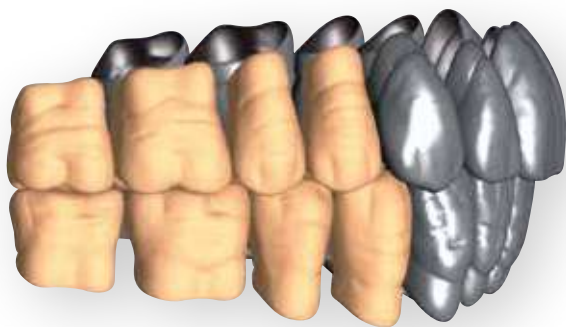

Geometric rear teeth with a 20° cusp angle, ideal for bilateral balance mounting with tooth-to-2-teeth occlusion.

Product	Code
Acry Plus 6 Upper	0120010
Acry Plus 6 Lower	0120011
Acry Plus 8 Upper	0120012
Acry Plus 8 Lower	0120013
Acry Plus Set 28 Teeth	0120014

Product	Code
Acry Plus V. 6 Upper	0120020
Acry Plus V. 6 Lower	0120021
Acry Plus V. 8 Upper	0120022
Acry Plus V. 8 Lower	0120023
Acry Plus V. Set 28 Teeth	0120024

# ACRYCETTE

MEDICAL  
DEVICE

Acry Cette is the system of acrylic polymer facings that, with its excellent aesthetic results, is practical and versatile and is ideal for the implementation of temporary removable dentures.

## Removable prostheses:

- Prostheses on implants and bar
- hybrid prostheses
- Toronto Bridge
- Telescopic work
- Bridges and bars with CAD/CAM milling
- Cast partial denture

## Fixed prostheses:

- Temporary aesthetic prostheses
- Lithium disilicate transformation
- Temporary prostheses for immediate loading
- Implant support restorations

**Frontal facings:** 6 upper and 4 lower incisor shapes  
Shades available A2 - A3 - A3,5

**Posteriors:** 3 upper and 3 lower diastoric shapes



## Advantages:

- Ease of use
- Ease of application
- Natural appearance
- High resistance to abrasion
- Transformable in lithium disilicate
- Perfect for scanning in occlusal shape, texture and anatomy



35° cusp angle



Product	Code
Acry Cette 6 Upper	0130001
Acry Cette 6 Lower	0130002
Acry Cette 8 Upper	0130003
Acry Cette 8 Lower	0130004

# Acrylic teeth

## ACRYLUX

MEDICAL  
DEVICE

Acrylic teeth in polymethylmethacrylate produced with three chromatic layers.

The main characteristics are:

- high aesthetical effect due to the 3 layers and due to the crown cut of incisal edges
- particular chemical-physical resistance due to the use of a high molecular weight resin
- large assortment of moulds and shades which make the teeth adaptable to any prosthesis requirement

**Range of:** 19 shades Acry Lux, 18 shades Acry Lux V, 25 moulds of upper anteriors, 12 lower anteriors and 16 posteriors

Product	Code
Acry Lux 6 Upper	0090001
Acry Lux 6 Lower	0090002
Acry Lux 8 Upper	0090003
Acry Lux 8 Lower	0090004
Acry Lux V. 6 Upper	0090009
Acry Lux V. 6 Lower	0090010
Acry Lux V. 8 Upper	0090011
Acry Lux V. 8 Lower	0090012
Acry Lux V. Set 28 Teeth	0090013
Acry Lux Set 28 Teeth	0100001



## ACRYROCK V

MEDICAL  
DEVICE

Acrylic teeth in polymethacrylate produced with two chromatic layers.

The main characteristics are:

- High aesthetical effect due the two layers
- Good chemical-physical resistance obtained by using the very best of raw materials
- Large assortment of moulds and shades which make the tooth adaptable to any prosthesis requirement

**Range of:** 19 shades, 32 moulds of upper anteriors, 19 lower anteriors and 22 posteriors.

Product	Code
Acry Rock V. 6 Upper	0010013
Acry Rock V. 6 Lower	0010014
Acry Rock V. 8 Upper	0010015
Acry Rock V. 8 Lower	0010016
Acry Rock V. Set 28 Teeth	0020003







## ACRYLIC TEETH - SUBSIDIARY PRODUCTS

### Live mould chart

#### Complete assortment of moulds.

It contains as well the shade guide of the line.

Product	Code
Live Mould Chart Acry Rock V.	0020004
Live Mould Chart EVO 2ST	0120085
Live Mould Chart Acry Lux	0110002
Live Mould Chart Acry Lux V.	0110004
Live Mould Chart Acry Plus	0120015
Live Mould Chart Acry Plus V.	0120025
Live Mould Chart Acry Plus EVO	0120046
Live Mould Chart Acry Smart	0120098



### Intro Kit

Kit containing 8 full sets (32 single sets) and Shade Guide Steel.

Product	Code
Intro Kit Acry Plus	0120055
Intro Kit Acry Plus V	0120056
Intro Kit Acry Plus Evo	0120057
Intro Kit Acry Smart	0120058
Intro Kit Acry Lux	0120066
Intro Kit Acry Lux V	0120067



# Shade guide

Basic Version:

- Acry Rock V - 19 shades
- Acry Lux - 19 shades
- Acry Lux V - 18 shades
- Acry Plus - 19 shades
- Acry Plus V - 16 shades
- Acry Plus EVO - 16 shades
- Acry Smart - 16 shades

Product	Code
Shade guide Acry Rock V.	0030002
Shade guide Acry Lux	0110001
Shade guide Acry Lux V.	0110003
Shade guide Acry Plus	0120016
Shade guide Acry Plus V.	0120026
Shade guide Acry Plus Evo	0120045
Shade guide Acry Smart	0120097

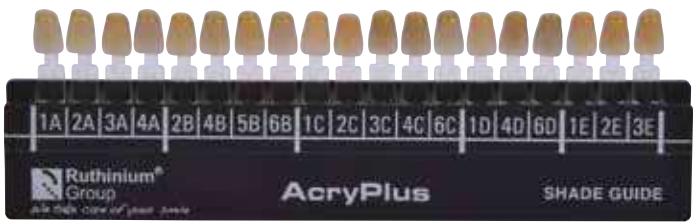

# Shade guide Steel

High Design Shade Guide with steel inserts.

Available in the following versions:

- Acry Plus - 19 shades
- Acry Plus V - 16 shades
- Acry Plus EVO - 16 shades
- Acry Smart - 16 shades

Product	Code
Shade guide Acry Plus Steel	0120060
Shade guide Acry Plus V. Steel	0120061
Shade guide Acry Plus Evo Steel	0120062
Shade guide Acry Smart Steel	0120095

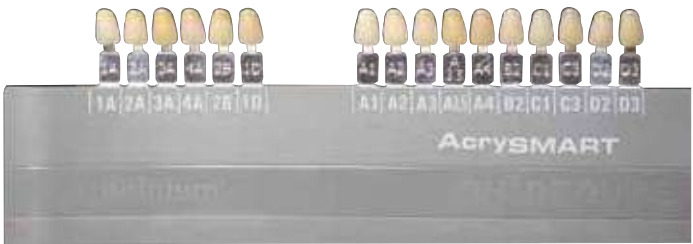



## X-RAY DIAGNOSTICS MATERIALS



## Acry Plus EVO RX

MEDICAL  
DEVICE

Acry Plus EVO RX is the line of radiopaque aesthetic teeth that enables the production of temporary dental prostheses, to be used as well as templates for TAC images capture.

Acry Plus EVO RX are available in the same moulds as Acry Plus EVO. This means temporary prostheses will be identical to definitive prostheses.

Product	Code
Acry Plus Evo Rx 6 Upper	0120047
Acry Plus Evo Rx 6 Lower	0120048
Acry Plus Evo Rx 8 Upper	0120049
Acry Plus Evo Rx 8 Lower	0120050
Acry Plus Evo Rx Set 28 Teeth	0120051



## Acry C&B RX

MEDICAL  
DEVICE

**Radiopaque C&B acrylic to be used for:**

- production of templates
- production of temporary c&b
- neck extension on radiopaque teeth

Product		Code
Acry C&B RX	100 g	0700050
Acry C&B Liquid Self Curing	60 ml	0690005



## Acry Self RX

MEDICAL  
DEVICE

**Radiopaque acrylic resin for palates.**

Ideal for the execution of templates in partial and total prostheses. Excellent for RX detailed capture in order to consider both progress and thickness of oral mucous.

Product		Code
Acry Self Rx Powder	100 g	1160002
Acry Self Rx Powder	500 g	1160001
Acry Self Liquid	50 ml	1030001
Acry Self Liquid	250 ml	1060003





RESINS

## Acry C&B

MEDICAL  
DEVICE

### High molecular-weight acrylic resin for:

- temporary works in the laboratory
- long-lasting temporary works
- aesthetic covering on metal crowns and bridges
- repairs

### Advantages:

- ease of use
- versatility
- high level aesthetic results
- abrasion and breakage resistant
- low bacterial plaque adhesion
- bio-compatibility



### Shades available for dentine, cervical and incisal:

A1 - A2 - A3 - A3,5 - B2 - C1 - C2 - D2 - D3 - Incisal 1 1A - 1C - 1D - 1E - 2A - 2B - 4A - 4B - Incisal 2

Product		Code
Acry C&B Dentine	40 g	0640001
Acry C&B Dentine	100 g	0640002
Acry C&B Dentine	500 g	0640003
Acry C&B Cervical	40 g	0650001
Acry C&B Cervical	100 g	0650002

Product		Code
Acry C&B Cervical	500 g	0650003
Acry C&B Incisal	40 g	0660001
Acry C&B Incisal	100 g	0660002
Acry C&B Incisal	500 g	0660003

## Acry C&B Liquids

MEDICAL  
DEVICE

**Regular.** For the traditional technique with flask.

**Special.** For the free stratification technique with spatula.

**Self Curing.** For repairs and temporaries.

Product		Code
Acry C&B Liquid Regular	60 ml	0670005
Acry C&B Liquid Regular	250 ml	0670006
Acry C&B Liquid Regular	500 ml	0670007
Acry C&B Liquid Special	60 ml	0680005
Acry C&B Liquid Special	250 ml	0680006

Product		Code
Acry C&B Liquid Special	500 ml	0680007
Acry C&B Liquid Self C.	60 ml	0690005
Acry C&B Liquid Self C.	250 ml	0690006
Acry C&B Liquid Self C.	500 ml	0690007



## Acry C&B Kit

### Temporary C&B Kit. Content:

3 x 40g Dentine • 1 x 40g Universal Incisal • 2 x 60ml Self Curing Liquid

**Accessories:** 1 Plastic dappen-dish • 1 Spatula

**Shades:** A2 - A3,5 - C2 or 2A - 2B - 4B

Product	Code
Acry C&B Kit	0590005



## Opaker

DISPOSITIVO  
MEDICO

### Opaque for crowns and bridges.

Good coverage and excellent metal-resin adherence.

### Shades:

A1- A2 - A3 - A3,5 - B2 - C1 - C2 - D2 - D3  
1A - 1C - 1D - 1E - 2A - 2B - 4A - 4B - Pink

Product		Code
Acry C&B Opaker	10 ml	0590004
Opaker Thinner	10 ml	0600001
Opaker Thinner	60 ml	0610001



# Resins for trays and Alginate

## Acry Tray

DISPOSITIVO  
MEDICO

**Self Cure resin for individual impression trays, plates for the registration of occlusions and for teeth set up.**

Minimum retraction coefficient and no waiting time, the mixture can be processed immediately after mixing.  
Measuring cup included in the pack.

**Colour:** pink

Product		Code
Acry Tray Powder	500 g	0720002
Acry Tray Powder	1.000 g	0750002
Acry Tray Powder	5.000 g	0780002
Acry Tray Liquid	250 ml	0730002
Acry Tray Liquid	500 ml	0760002
Acry Tray Liquid	2.500 ml	0780003



## Plaque Photo

DISPOSITIVO  
MEDICO

**Bases of light cure resin, that are very simple to use, have excellent dimensional stability and twisting resistance.**

**Plaque Photo bases can be used for:**

- individual impression trays
- functional impression trays
- bases for mounting teeth in removable dentures
- bite plates

**Colours:** Pink - Neutral - Blue

Product		Code
Plaque Photo	50 pcs	0800013



## Alginato

DISPOSITIVO  
MEDICO

**Alginato for high precision dental impressions.**

Available in both Chromatic and Dust Free.  
Packaging of 24 bags of 450g each.

**Chromatic:** Alginato with colour changes

**Flavour:** Mint

**Chromatic variations:** Violet - Mixing  
Cyclamen - Working  
Green - Mouth insertion

**Dust Free:** Fast mixing and setting time

**Gusto:** Mint

**Colore:** Green

Product		Code
Alginato - Chromatic	450 g	2040003
Alginato - Dust Free	450 g	2060003



# Hot cure resins for removable prostheses

## Acry Pol R

MEDICAL  
DEVICE

Heat cure resin (PMMA) suitable for complete, partial and combined removable dental prostheses and for denture base reconstruction.

**Main advantages:** • good mechanical resistance • stability of colour and dimensions • natural appearance

Packaging with measuring spoon.

**Shades:** V3 - V4 - V7 - Pink - Neutral

Product		Code	Product		Code
Acry Pol R Powder	500 g	0820002	Acry Pol R Liquid	250 ml	0830002
Acry Pol R Powder	1.000 g	0850002	Acry Pol R Liquid	500 ml	0860002
Acry Pol R Powder	5.000 g	0880002	Acry Pol R Liquid	2.500 ml	0880003



## Acry Pol Fast

MEDICAL  
DEVICE

Heat cure resin (PMMA) for the production of total, partial prostheses as well as combined dental prostheses.

**Main advantages:** • dimensional stability  
• natural shades  
• the flask can be placed directly into boiling water

Packaging with measuring spoon.

**Shades:** V3 - V7 - V10

Product		Code	Product		Code
Acry Pol Fast Powder	500 g	1000200	Acry Pol Fast Liquid	250 ml	1000203
Acry Pol Fast Powder	1.000 g	1000201	Acry Pol Fast Liquid	500 ml	1000204
Acry Pol Fast Powder	5.000 g	1000202	Acry Pol Fast Liquid	2.500 ml	1000205



## Acry Pol LL

MEDICAL  
DEVICE

Heat cure resin (PMMA) with a high molecular weight. Suitable for complete, partial and combined removable dental prostheses.

**Main advantages:** • high mechanical resistance  
• the long period of plasticity (1 hour) allows flasking several prostheses

Packaging with measuring spoon.

**Shades:** V3 - V4 - V7 - V10 - OP1 - Pink - Neutral

Product		Code	Product		Code
Acry Pol LL Powder	500 g	0920002	Acry Pol LL Liquid	250 ml	0930002
Acry Pol LL Powder	1.000 g	0950002	Acry Pol LL Liquid	500 ml	0960002
Acry Pol LL Powder	5.000 g	0980002	Acry Pol LL Liquid	2.500 ml	0980003



## Acry Pol HI

DISPOSITIVO  
MEDICO

High molecular weight heat cure resin (PMMA). Suitable for complete, partial and combined removable dental prostheses.

**Main advantages:** • high mechanical resistance and high resistance to breaking-point loads even with reduced thickness • ideal for lightweight prostheses • excellent aesthetic effect

Packaging with measuring spoon.

**Shades:** H3 - H4 - OP1

Product		Code	Product		Code
Acry Pol HI Powder	500 g	1000300	Acry Pol HI Liquid	250 ml	1000301
Acry Pol HI Powder	1.000 g	1000302	Acry Pol HI Liquid	500 ml	1000303
Acry Pol HI Powder	5.000 g	1000304	Acry Pol HI Liquid	2.500 ml	1000305





# Self cure resins

## Acry Self

MEDICAL  
DEVICE

**Polymerizable cold-curing acrylic resin (PMMA) for removable dental prostheses, repairs and relining.** Particularly indicated for the injection technique.

### Advantages:

- Ease of working
- Excellent plasticity
- Colour stability
- Perfect adhesion

Packaging with measuring spoon.

**Shades:** V3 - V4 - V7 - V10 - H3 - H4 - OP1 - Pink - Neutral

Product		Code	Product		Code
Acry Self Powder	100 g	1020001	Acry Self Liquid	50 ml	1030001
Acry Self Powder	500 g	1050002	Acry Self Liquid	250 ml	1060003
Acry Self Powder	1.000 g	1080003	Acry Self Liquid	500 ml	1090003
Acry Self Powder	5.000 g	1110002	Acry Self Liquid	2.500 ml	1110003



## Acry Self P

MEDICAL  
DEVICE

**Cold curing resin (PMMA) to be used with casting technique.**

For cast partial denture, removable dental prostheses and repair.

### Advantages:

- high fluidity and easy to work
- colour stability
- perfect adhesion

Packaging with measuring spoon.

**Shades:** V3 - V4 - V7 - V10 - OP1

Product		Code	Product		Code
Acry Self P Powder	500 g	1150002	Acry Self P Liquid	250 ml	1150003
Acry Self P Powder	1.000 g	1150005	Acry Self P Liquid	500 ml	1150006
Acry Self P Powder	5.000 g	1150008	Acry Self P Liquid	2.500 ml	1150009



## Acry Ort SC

MEDICAL  
DEVICE

**Self-cure acrylic resin (PMMA) for orthodontic plates and the construction of bites.**

Simple to work and featuring high transparency.  
Recommended for the spray technique.

Packaging with measuring spoon.

**Shades:** Trasparent

Product		Code	Product		Code
Acry Ort SC Powder	500 g	1220002	Acry Ort SC Liquid	250 ml	1230002
Acry Ort SC Powder	1.000 g	1250002	Acry Ort SC Liquid	500 ml	1260002
Acry Ort SC Powder	5.000 g	1280002	Acry Ort SC Liquid	2.500 ml	1290002





## RESINS FOR 3D PRINT

# Resins for 3D print

## RU-001 Temporary

**Code product: 0220001**

Light-curing resin suitable for use in combination with extraoral light-curing devices. Biocompatible 3D printing resin for additive manufacturing of temporary crowns and bridges. Temporaries created with **ACRY Print 3D RU-001 Temporary** resin can be fixed with common dental cements. **ACRY Print 3D RU-001 Temporary** consists of functional methacrylic resins and inorganic fillers with particle sizes from 0.4 to 3 microns.

**Packaging:** 1000g

**Shades:** A2 - A3

### Advantages

- Biocompatible materials
- Excellent mechanical properties
- Low viscosity
- Easy clean-up
- Radiopaque

**MD**  
**CLASSE IIA**



## RU-002 Model

**Cod product: 0220002**

Light-curing resin suitable for use in combination with extraoral light-curing devices. Indicated for the production of prosthetic and orthodontic dental models. **ACRY Print 3D RU-002 Model** consists of functional methacrylic resins, initiators, colorants and stabilizers.

**FOR EXTRA-ORAL USE ONLY.**

**Packaging:** 1000g

**Shades:** Grey

### Advantages

- High dimensional stability
- Optimized aesthetic
- Implementable into the digital stream

## RU-003 Try-In

**Code product: 0220003**

Light-curing polymerizable resin to be used along with extraoral light-curing devices. Indicated for the production of functional try-ins, full dentures and aesthetic mock-ups. **ACRY Print 3D RU-003 Try-In** consists of functional methacrylic resins, initiators, dyes and stabilizers.

**Packaging:** 1000g

**Shades:** A2

### Advantages

- Greater biocompatibility
- Clinical Safety / Increased Impact Resistance /
- Significantly improved chemical-physical values
- High impact

**MD**  
**CLASSE I**





## RU-004 Denture HI

**Code product: 0220004**

Light-curing resin suitable for use in combination with extraoral light-curing devices. Indicated for the production of both full or partial dentures and functional denture bases. **ACRY Print 3D RU-004 Denture HI** consists of functional methacrylic resins, initiators, dyes and stabilizers.

**Packaging:** 1000g

**Shades:** Orange-Pink

### Advantages

High fitting accuracy

High impact

**MD**  
**CLASSE IIA**



## RU-005 Guide

**Code product: 0220005**

Light-curing resin suitable for use in combination with extraoral light-curing devices. Indicated for the production of splints and prosthetic and orthodontic bite planes. **ACRY Print 3D RU-005 Guide** consists of functional methacrylic resins, initiators, colorants and stabilizers.

**Packaging:** 1000g

**Shades:** Trasparent

### Advantages

Exceptional stretching

High transparency

High UV stability

Optimal optical control

Sterilizable

**MD**  
**CLASSE IIA**





## CAD-CAM MATERIALS

## Ruthinium Disc

MEDICAL  
DEVICE

PMMA discs for fabrication of temporary crown and bridges, manufactured with high molecular cross-linked acrylic which guarantees high detailed precision and resistance.

### Advantages:

- High milling reproduction details
- Absence of cracks even on thinner layers
- Resistance to abrasion
- Fluorescence
- Burns out completely
- Chromatic stability and absence of porosity
- Biocompatibility



Product	Code	Product	Code
Ruthinium Disc	7900087	Ruthinium Disc A	7900089
Ruthinium Disc Multilayer	7900088	Ruthinium Disc A Multilayer	7900090

## RuthiniumDISC

### Ruthinium Disc Monocromatico

Shades	A1 – A2 – A3 – A3,5 – B1 – B2 – C3 PINK – TRANSPARENT – RX
Sizes	<div>Ø 98,5 mm</div> <div>Ø 95 mm</div> <div>Ø 72 mm</div>
Thickness	16 mm – 20 mm – 25 mm

## RuthiniumDISC MULTILAYER

### Ruthinium Disc Multilayer

Shades	A1 – A2 – A3 – A3,5 – B1 – B2 – C3
Sizes	<div>Ø 98,5 mm</div> <div>Ø 95 mm</div> <div>Ø 72 mm</div>
Thickness	16 mm – 20 mm – 25 mm

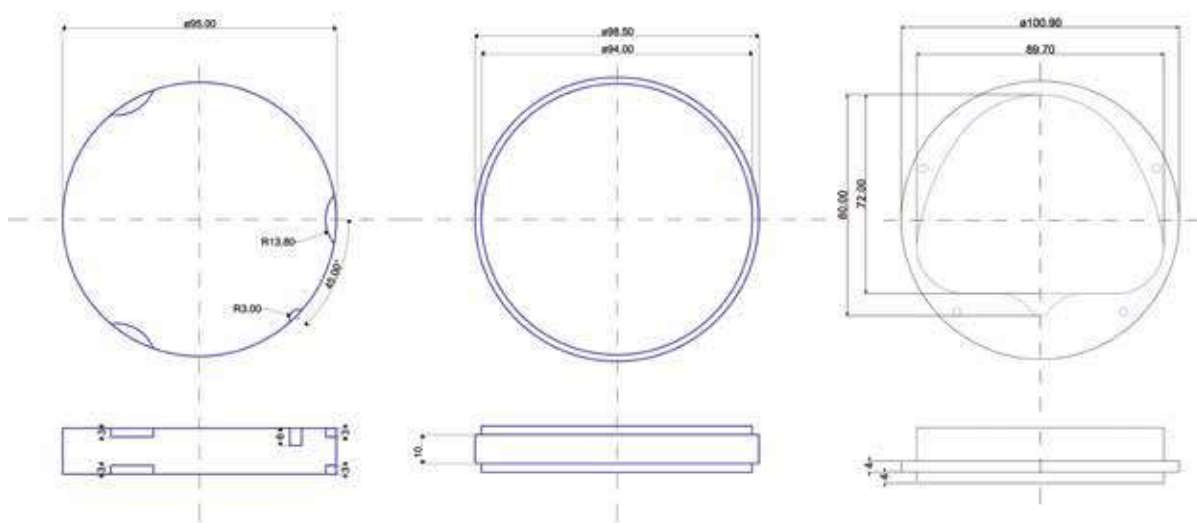

# Ruthinium **DISC** easy

MEDICAL  
DEVICE



SOFTER. MORE PLIABLE.

**Same quality as always.**

We have responded to the demand for a more versatile and easily processed CAD/CAM material. Compared to our other DISCS, this one is softer and more suitable for CAD/CAM temporary restorations.

**Product**

Ruthinium Disc Easy

**Code**

7900095

## SPECIFICATIONS



**PACKx5**

Product marketed in  
**packs of 5 pieces.**  
5 instructions included.

**CLASS I**  
Produced for  
TEMPORARIES

### AVAILABLE COLOURS

A2 - A3

### AVAILABLE THICKNESSES

16mm

20mm

ATTACHMENT  
STANDARD  
**98,5mm**

**RUTHINIUM DISC HARDNESS** (*Vickers hardness*)



## PLASTERS

## Ruthinium Stone 3

**Hard Dental Plaster (type III) for the preparation of models and prosthesis flasking.**

**Shades:** yellow

**Packaging:** 25kg bag

Product		Code
Ruthinium Stone 3	25 Kg	2230001



## Hardstone

**Hard Dental Plaster (type III) for mobile prostheses. Greater hardness and resistance to abrasion.**

High quality models, excellent prosthesis results.

**Shades:** yellow

**Packaging:** 25kg bag, 5kg jar

Product		Code
Hardstone	5 Kg	2290002
Hardstone	25 Kg	2290003



## Ruthinium Stone 4

**Extra hard plaster for stumps (type IV).**

Preparation of removable stumps and models. Excellent results in the production of models.

For removable prostheses and cast partial dentures. High resistance to abrasion and compression.

**Shades:** light brown

**Packaging:** 25kg bag, 5kg jar

Product		Code
Ruthinium Stone 4	5 Kg	2420001
Ruthinium Stone 4	25 Kg	2430001



## Acry Film

**Insulating material for plaster.**

Rapid absorption. Creates a thin, resistant film between the plaster and the resin.

The solution penetrates the plaster in depth and completely obstructs the micro pores without varying the dimensions of the model.

Product		Code
Acry Film	250 ml	0170001
Acry Film	500 ml	0160001
Acry Film	1.000 ml	0150001
Acry Film	5.000 ml	0150002



## Silicon Film

Low viscosity addition-curing silicone insulator for insulation of resin-gypsum, resin-resin, resin-metal, composite gypsum. Forms a resistant and thin film that is colourless and odourless.

Product		Code
Silicon Film	50 ml	2170001





## DUPLICATING MATERIALS

## Labor Mass

**C-Silicon for laboratory. Hardness: 85Sh.A.**

**Uses:**

- Repairs and packing of prostheses
- Masks
- Duplication of moulds
- Separation teeth-plaster in the mould

**Features:**

- Soft in mixing phase
- No reaction with the resins
- Excellent dimensional stability
- Excellent heat resistance

Product		Code
Labor Mass	5 Kg	2180004
Labor Mass + 3 Cat.	5 Kg	2180006



## Labor Mass Hard

**C-Silicon for high hardness and rigidity requirement.**

Hardness: 95Sh.A. For high hardness and rigidity needs.

**Features:**

- Soft in mixing phase
- No reaction with the resins
- Excellent dimensional stability
- Excellent heat resistance

Product		Code
Labor Mass Hard	5 Kg	2180005
Labor Mass H. + 3 Cat.	5 Kg	2180007



## Activator Paste

**Catalyst in gel.**

**Packaging:** 60 ml.

Product		Code
Activator Paste	60 ml	2150001



## Stargel HP Hard

**A-Silicon for model duplication, compatible with all plasters, coatings or spreadable resins.**

For all duplication techniques. Hardness: 23Sh.A.

**Packaging:** 1kg+1Kg is 5Kg+5Kg.

Product		Code
Stargel HP Hard	2 Kg	3520003
Stargel HP Hard	10 Kg	3520005





# Duplistar 90

A-Silicon for control masks preparation, occlusal registration keys, duplication of full and partial dentures, masks for temporary prosthesis preparation, ceramic moulding, partial counterdies in flask.

- Hardness: 90Sh.A
- Extra-rigid

Product		Code
Duplistar 90	1,5+1,5 Kg	2180009
Duplistar 90	5 + 5 Kg	2180011



# Stargel

Gel for duplicating models with chrome-cobalt investment.

It has a very low melting point (80°), meaning it may be used with all types of melting systems or duplicating machines. Its elasticity and fluidity guarantee very precise duplications. It can be used for at least 10 duplications.

Product		Code
Stargel	4 Kg	3540001
Stargel	10 Kg	3550001
Stargel	20 Kg	3550002





## INVESTMENTS AND PLASTIFORM

## Casting Investment Fine

### Silicon bonding investment for chrome cobalt casting.

Ideal for free expansion techniques.

Very precise and limited oxidation to chrome-cobalt alloy castings.

- Max. heating temperature: 1,150 °C
- Working time: 10-15 min
- Hardening time: 20-30 min

Product	Code
Casting Investment Fine	20 Kg 3470002



## Liquid A+B

### Silicon binder in alcohol solution liquid for Casting Investment Fine.

A very strong binder for producing cylinders without containment collar.

Product	Code
Liquid A+B	3.000 ml 3200007



## Cromo Casting Fast

### Phosphate investment for chrome-cobalt castings.

Very precise, resistant and easy to use in rapid and traditional techniques.

**Packaging:** 50 pre-dosed bags of 400g.

Product	Code
Cromo Casting Fast	20 Kg 3770002



## Kera Casting Fast

### Phosphate investment for bridges and crowns, pressable ceramic and lithium disilicate. Use with both rapid and standard methods.

Its characteristic, fine grain and absence of graphite means even the tiniest details are reproduced. Suitable for all types of castings in fixed prostheses (precious and non precious alloys).

**Packaging:** 28 pre-dosed bags of 160g.

Product	Code
Kera Casting Fast	4.480 g 4150001



## Ruthinium Liquid

### Liquid for Cromo Casting Fast and Kera Casting Fast.

Product	Code
Ruthinium Liquid	750 ml 3810001
Ruthinium Liquid	1.000 ml 3850001
Ruthinium Liquid	5.000 ml 3860001



## Plastiform

### Plastic preformed models for modelling cast partial dentures.

No residuals are left in the heating oven to produce a casting free of imperfections. Available in 56 shapes for any sort of need. 10 blister pack.



Plastiform B1 10 pcs 3100B1



Plastiform B2 10 pcs 3100B2



Plastiform B3 10 pcs 3100B3



Plastiform B4 10 pcs 3100B4



Plastiform B5 10 pcs 3100B5



Plastiform B6 10 pcs 3100B6



Plastiform BC0 10 pcs 3100BC0



Plastiform BC1 10 pcs 3100BC1



Plastiform BC2 10 pcs 3100BC2



Plastiform BD1 10 pcs 3100BD1



Plastiform BD2 10 pcs 3100BD2



Plastiform BL1 10 pcs 3100BL1



Plastiform BL2 10 pcs 3100BL2



Plastiform BP0 10 pcs 3100BP0



Plastiform BP1 10 pcs 3100BP1



Plastiform BR1 10 pcs 3100BR1



Plastiform BR2 10 pcs 3100BR2



Plastiform CD1 10 pcs 3100CD1



Plastiform CD2 10 pcs 3100CD2



Plastiform CR1 10 pcs 3100CR1

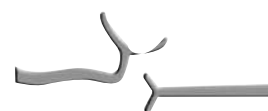

Plastiform CRC 10 pcs 3100CRC



Plastiform FC0 10 pcs 3100FC0



Plastiform FC1 10 pcs 3100FC1



Plastiform GC1 10 pcs 3100GC1



Plastiform GC2 10 pcs 3100GC2



Plastiform GC3 10 pcs 3100GC3



Plastiform GC5 10 pcs 3100GC5

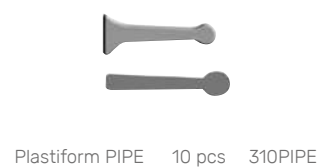
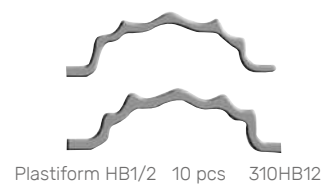
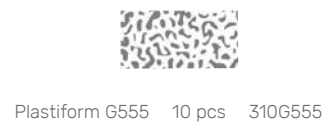
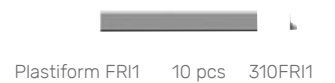
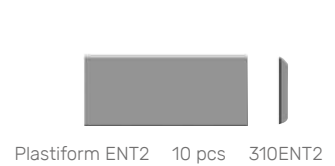
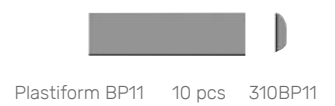
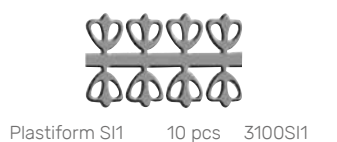
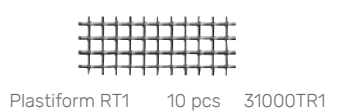
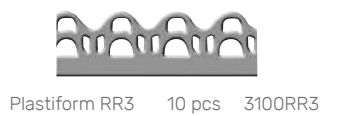
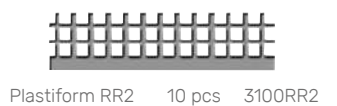
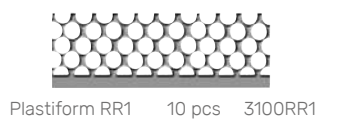
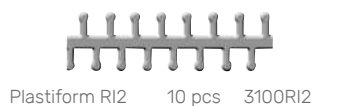
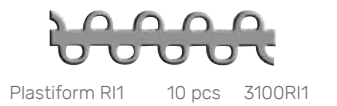
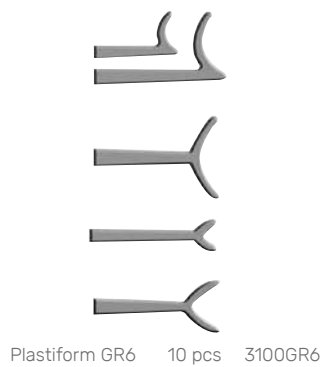
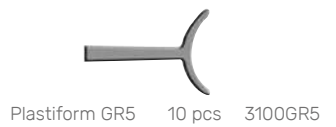
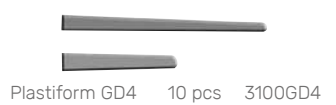
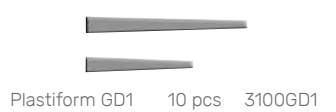
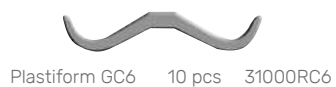



## POLISHING AND FINISHING PRODUCTS

## Bristle brushes

**For finishing of dental alloys and smoothing of resin.**

Wooden centre, black bristle, very strong. Diameter 80 mm.

Product		Code
Convergent layers	5 pcs	5480002
Parallel layers	5 pcs	5490002



## Brushes for polishing

**Brushes for polishing dental alloys and resins.**

Available in black, white and goat bristle. Diameter 50 mm.

**Packaging:**

- 5 bristle pack

Product		Code
Black bristle	5 pcs	5510002
White bristle	5 pcs	5520002
Goat bristle	5 pcs	5530002



## Bristle brush

**Black bristle brush for cleaning the workstation.**

Total length 200mm, bristle length 47mm.

Product		Code
Bristle brush 200x47 mm		5560001



## Metalux

**Abrasive paste used for polishing and roughing of precious and not precious alloys.**

Product		Code
Metalux Green	1.000 g	5570001
Metalux Green	500 g	5580001





## Acry Lux Paste

Abrasive paste for polishing of dentures.

Product		Code
Acry Lux Paste	1.000 g	5650001
Acry Lux Paste	500 g	5660001



## Acry Lux Cream

Cream for shining of dentures.

Product		Code
Acry Lux Cream	250 g	5680001
Acry Lux Cream	100 g	5690001



## Acry Lux Liquid

Liquid for shining of dentures.

Product		Code
Acry Lux Liquid	1.000 ml	5700001
Acry Lux Liquid	250 ml	5710001



## Pumice

Italian volcanic pumice, maximum purity and extra fine grain.

Used for honing of total or partial removable prostheses.

Product		Code
Pumice	5 Kg	5720001
Pumice	10 Kg	5730001
Pumice	20 Kg	5750001







WAXES

# Waxes

## Hartiwx

MEDICAL  
DEVICE

### Bite rims in rigid beige wax.

They are characterized by a curved morphology that replicates the inclination and thickness of natural teeth.

Product		Code
Hartiwx	36 pcs	6100001



## Calibrated wax

### Sheets of calibrated wax for modelling cast partial dentures.

Available in the smooth or stippled versions.  
Pliable and hard wearing, it does not leave any residual deposits during casting.

Product		Code
Smooth Calibrated Wax 0,3 mm	10 pcs	6140001
Smooth Calibrated Wax 0,4 mm	10 pcs	6140002
Smooth Calibrated Wax 0,5 mm	10 pcs	6140003
Smooth Calibrated Wax 0,6 mm	10 pcs	6140004
Smooth Calibrated Wax 0,7 mm	10 pcs	6140005
Smooth Calibrated Wax 0,8 mm	10 pcs	6140006
Stippled Calibrated Wax 0,3 mm	10 pcs	6150001
Stippled Calibrated Wax 0,4 mm	10 pcs	6150003
Stippled Calibrated Wax 0,5 mm	10 pcs	6150004
Stippled Calibrated Wax 0,6 mm	10 pcs	6150005



## Tenasyle

MEDICAL  
DEVICE

### Pink wax in sheets for modelling removable prostheses.

Can be used throughout the year.  
When heated moulds easily and quickly.

Product		Code
Tenasyle	500 g	6170006





DIGITAL

## The new Digital Age

We have created a complete digital system to bring the daily process of designing and constructing dentures into the future.

From the photographic preview of the smile to completion of the denture project with Ruthinium® ACRYSMART, achieving patient satisfaction has never been so easy and fast.

## Our DIGITAL MANIFESTO

### We believe in manual talent

Dental technicians and their manual talent are the real driving force towards a future of highly functional and aesthetically extraordinary dentures..

### We believe that digital is an instrument:

To develop communication between the dental technician, dentist and patient.

To reassure patients with credible previews of their dentures.

To shorten the time from prototype to final result.

To bring cost and time efficiency to the denture creation process.

To combine traditional experience with a technological approach.

### We want to be protagonists in dentistry innovation

#### MORE TIME FOR YOUR ART

Save time on prototypes and attempts

#### EASY DIGITAL APPROACH

No learning curve. Digital designed for dentistry

#### EASY ASSEMBLY

With Denture Guide and preset settings to help dental technicians and dentists

## The Ruthinium digital workflow

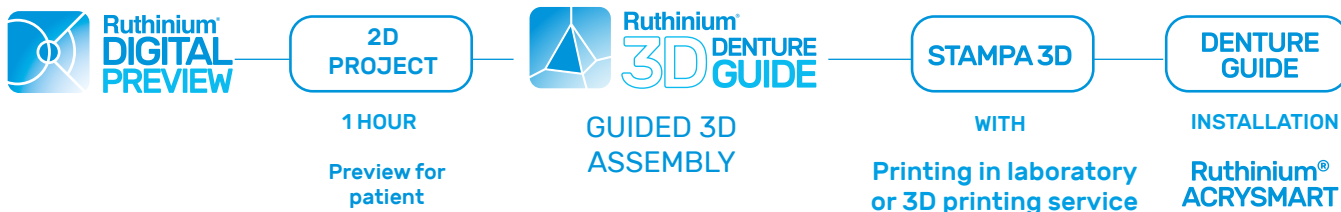

Product	Code
Ruthinium Digital Preview	7910001
Ruthinium 3D Denture Guide	7930001
Acry Smart tooth library	7920001



Ruthinium Digital Preview is a photo editor that allows users to obtain a quick and realistic preview of denture projects directly on the patients' faces. It is a communication tool between the dentist and the dental technician, and a diagnostic tool between the dentist and the patient. With its easy protocol and intuitive software, Ruthinium Digital Preview allows dentists to show patients a preview of their smile in just an hour and a half.

PREVIEW IN  
JUST  
1 HOUR



**Import your 2D project**  
**Assemble easily in 3D**  
**Create your Denture Guide**

Ruthinium 3D Denture Guide is a 3D modelling software that assists dental technicians in the correct positioning of acrylic teeth in denture projects for edentulous patients, showing the positioning result directly on the face and mouth of the patient. The software combines a photographic preview with a precise 3D positioning of the tooth for the printing of a Denture Guide that is ready for easy installation of teeth.

PATENTED

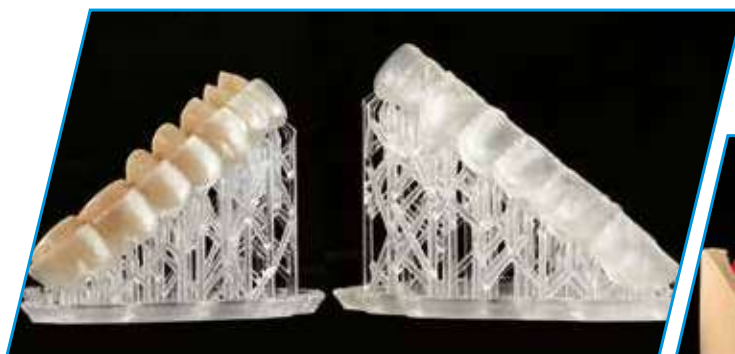

WE TAKE  
CARE  
OF YOUR  
**SMILE**

[info@ruthinium.it](mailto:info@ruthinium.it)  
[ruthinium.it](http://ruthinium.it)

**Ruthinium®**

**Dental Manufacturing S.P.A.**

Via Cà Mignola Nuova, 1699 - 45021 Badia Polesine (RO)

**P.IVA 01039350291 CF 01058640283**

**Tel. +39 0425 51628**